

DESCRIPTION

UNIPOWER's DPPIU Series of circuit breaker panels provide distribution and overload protection for 1 to 16 circuits with circuit breakers that can be field installed/exchanged without the need for any additional tools. The panels are only one mounting position (1.75 inches) high.

The panels provide up to 16 breakers single-bus 150A or dual-bus 300A (8A/8B) distribution and alarm capabilities. The A and B sections of the dual-bus panel are fully isolated. Breaker capacities range from 1 to 30 amperes.

Breaker alarm is indicated by a dual color LED (green/red) and Form C relay contacts for each bus.

FEATURES

- ◆ 48/24V Dual Voltage
- ◆ POLARITY NEUTRAL
- ◆ 150A bus bar inputs
- ◆ Single or Dual Feed
- ◆ NO tools required to change breakers
- ◆ Tapered entry for easy insertion
- ◆ NO or NC alarm contacts
- ◆ Alarm LEDs
- ◆ Power Fail form-C alarm
- ◆ 19" & 23" universal mounting brackets
- ◆ Rear panel safety cover standard

THREE YEAR WARRANTY

SAFETY CERTIFICATIONS

UL60950-1 2nd Edition
 CSA22.2, No. 60950-1 2nd Edition
 EN60950-1 2nd Edition



DUAL FEED CONFIGURATION

| MODEL NUMBER | VOLTS EACH FEED | INPUT FEEDS | MAX. # BREAKERS | AMPS EACH FEED | TOTAL AMPS |
|--------------|-----------------|-------------|---------------------|----------------|------------|
| DPPIU-AI-BI | 48/24 - 48/24 | 2 | 8 A Side & 8 B Side | 150 | 300 |

SINGLE FEED CONFIGURATION

| MODEL NUMBER | VOLTS EACH FEED | INPUT FEEDS | MAX. # BREAKERS | AMPS EACH FEED | TOTAL AMPS |
|---------------|-----------------|-------------|-----------------|----------------|------------|
| DPPIU-AI-BI-S | 48/24 - 48/24 | 1 | 16 | 150 | 150 |

Note: All panels are shipped with 15 breaker position blanking plates.

BREAKER ORDERING GUIDE

| AMPS | PART NUMBER |
|-------|---------------|
| 1 | 348-1436-0000 |
| 2.5 | 348-1436-0010 |
| 5 | 348-1436-0020 |
| 10 | 348-1436-0030 |
| 15 | 348-1436-0040 |
| 20 | 348-1436-0050 |
| 25 | 348-1436-0060 |
| 30 | 348-1436-0070 |
| BLANK | 348-1418-0000 |

NOTE: Breakers need to be ordered individually and are shipped with each panel as separate items for field installation.

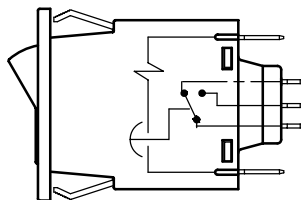

SPECIFICATIONS

Typical at 25°C Unless Otherwise Noted.

INPUT/OUTPUT

| | |
|-------------------------------------|--|
| Input/Output Ratings..... | 150A Max. @ 40°C, each side A & B 125A Max. @ 50°C, each side A & B 50A Max. @ 70°C, each side A & B See manual for details on CB deratings |
| Configuration..... | 150A Single Bus with 1 to 16 Breakers 300A Dual Bus 1 to 8 Breakers Each Bus |
| Breaker Capacity ¹ | 1A to 30A |
| Voltage ¹ | |
| 24/48V Version | 21-60VDC |
| 12V Version..... | 10.5-15VDC |
| Polarity | Neutral, Positive or Negative Ground |

ALARMS

| | |
|-----------------------------|---|
| Alarm Indicator | Dual Color LED Per Bus |
| LED Status Indication | Green = Normal Red = CB Trip Alarm Off = No Power |
| Alarm Relays..... | Form C Contacts for each Bus |

| | |
|--------------|--|
| SAFETY | UL60950-1 2 nd Ed., CSA22.2 No. 60950-1 2 nd Ed., EN60950-1 2 nd Ed. |
|--------------|--|

ENVIRONMENTAL

| | |
|----------------------------|---------------------------|
| Operating Temp. Range..... | -10°C to +70°C |
| Storage Temp. Range | -40°C to + 85°C |
| Humidity | 0% to 95%, Non-Condensing |

PHYSICAL SPECIFICATIONS

| | |
|------------------------------------|---|
| Case Material | Steel |
| Finish..... | Powder Coat Black |
| Case Dimensions, Inches (mm) | 1.74 H x 17.12 W x 8.94 D (44.2 x 434.9 x 227.1) |
| Weight | 10.30 lbs. (4.67 kg.) |
| Rack Mounting | 19 or 23 Inch |

CONNECTIONS

| | |
|--------------------------------|-----------------------------------|
| Input Connections..... | Crimp Type Lug or ¼ - 20 Stud |
| Output Connections..... | Barrier Terminal Strips, No. 6-32 |
| Chassis Ground Connection..... | No. 8-32 Stud |
| Alarm Relay Connections | Spring Clamp Terminals, 16-26AWG |

Notes:

1. See ordering guide to specify.

FRONT VIEW

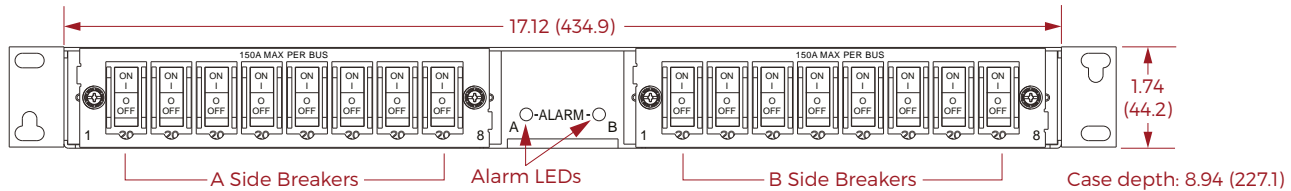

REAR VIEW

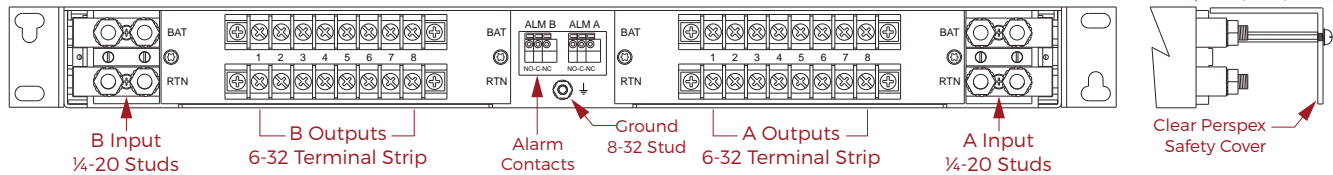

ALL DIMENSIONS IN INCHES (mm).

BUS BAR / TERMINAL DETAIL

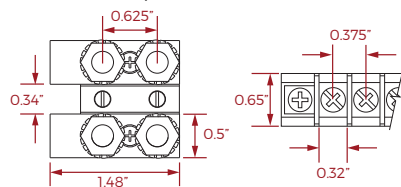

Crimp Lugs for input bus bars should be ordered separately.
For a kit of 4 two-hole lugs for no. 6 AWG wire order pt. no. 775-1434-0000.

ALARM CONNECTOR DETAIL

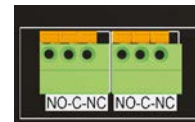

Connectors are Phoenix Contact spring clamp type.
Wires (16-26AWG) do not require any termination.

NOTE: Single feed models DPPIU-A1-B1-S and DPPIU-A6-B6-S have both left and right side input bus bars fitted. It is only necessary to connect the input feed to one side for correct operation.

The unused side is directly connected to the live input feed and can be used for supplying additional panels.

The total load must not exceed 150A on any one pair of bus bars in the chain.

© 2020 UNIPOWER LLC

This document is believed to be correct at time of publication and Unipower LLC accepts no responsibility for consequences from printing errors or inaccuracies. All specifications subject to change without notice.

North America & CALA: +1 954-346-2442 • EMEA: +1 561-990-3830 • sales@unipowerco.com